

TYPE B AND C SOAKAWAY DETAIL

SOAKAWAY TYPE	IMPERMEABLE AREA	INFILTRATION RATE	OVERALL DIMENSION	INTERNAL DIMENSION	WORKING DEPTH
B	475	0.022	1000 x 1000	1000	2000
C	400	0.022	800 x 800	1000	2000

REFER TO HVA SUPPLEMENTARY INVESTIGATION WORKS FOR SOAKAWAY TEST RESULTS

**ADDITIONAL PLAN**

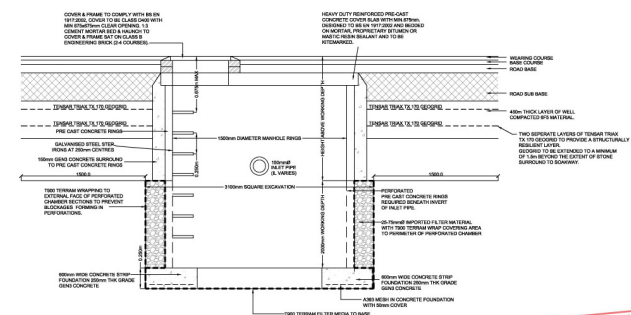

TYPE A SOAKAWAY DETAIL

NOTE: WORKING DEPTH OF SOAKAWAY TO BE ENTIRELY WITHIN SUITABLE SAND STRATA.

RISK ASSESSMENT	LEVEL OF RISK	SUGGESTED ACTION
SOAKAWAY STRUCTURE ASSOCIATED WITH HIGH DRAINAGE WATER	HIGH	ENSURE ALL SOAKAWAYS HAVE SUFFICIENT TRENCH SUPPORTS
UNDESIRABLE LARGE DIAMETER WHEELS AND CIRCULES OVER	HIGH	USE CONCRETE INTERNAL CURBS AND 200mm DEPTH CONCRETE
CONCRETE WITH REINFORCE	MED	OPERATIONS TO USE CORRECT REINFORCEMENT EQUIPMENT CONNECTIVE
SOAKAWAY	MED	OPERATIONS TO USE CORRECT EQUIPMENT TO CONSTRUCT
DRAINAGE EXISTENTIAL ALIGNED EXISTING BOUNDARY STRUCTURES	HIGH	ENSURE ALL EXISTENTIALS ARE PROTECTED TO TRENCHES AND
DRAINAGE EXISTENTIALS IN EXISTING TRENCHES	HIGH	ENSURE ALL EXISTENTIALS ARE PROTECTED TO TRENCHES AND
MAINTAIN ACCESS TO ADJACENT PROPERTIES AND OCCUPANTS	HIGH	TRENCH WORK SHALL PROTECT ALL ADJACENT PROPERTIES AND
SOAKAWAY EXISTENTIALS TO BE PROTECTED	HIGH	ENSURE ALL EXISTENTIALS ARE PROTECTED TO TRENCHES AND
WORKING IN COMPACTED SPECIES WORKING IN DRAINAGE AND SERVICES	HIGH	ENSURE ALL EXISTENTIALS ARE PROTECTED TO TRENCHES AND
WORKING IN EXISTENTIALS FROM VEHICLE AND PLANT	HIGH	ENSURE ALL EXISTENTIALS ARE PROTECTED TO TRENCHES AND
ROAD AND DRAINAGE CONSTRUCTION	HIGH	ENSURE ALL EXISTENTIALS ARE PROTECTED TO TRENCHES AND
OPERATIONS/WORKERS ON SITE	LOW	ENSURE ALL EXISTENTIALS ARE PROTECTED TO TRENCHES AND

THIS COPY MUST BE IN ACCORDANCE WITH THE ACCURACY OF WORKING DRAWINGS AND SHOULD BE USED FOR THE CONSTRUCTION OF THE SOAKAWAY. ANY CHANGES TO THE DRAWINGS MUST BE APPROVED BY THE DESIGNER AND MUST BE IN ACCORDANCE WITH THE ACCURACY OF WORKING DRAWINGS AND SHOULD BE USED FOR THE CONSTRUCTION OF THE SOAKAWAY.

**Haigh Huddleston & Associates**  
Civil Structural Engineering Consultants

Firth Buildings, 48 - 101 Leeds Rd, Doncaster, WF12 7SU 01524 464342 1 01524 459602  
+ hva@haighhuddleston.co.uk

Client  
**MR J. B. COOK**

Project  
**56 LOW MOORGATE, RILLINGTON, MALTON**

Drawn  
**TYPICAL HIGHWAY SOAKAWAY DETAILS**

DATE  
**06/07/16**

Rev: 004 Date: JUN16 Scale: 1:25@A1 E:\25666\06

THIS PLAN MUST BE USED IN CONJUNCTION WITH THE PROPOSAL FOR PROPOSED SOAKAWAYS. ANY CHANGES TO THE PROPOSED SOAKAWAYS MUST BE APPROVED BY THE LOCAL AUTHORITY. THIS PLAN MUST BE USED IN CONJUNCTION WITH THE PROPOSAL FOR PROPOSED SOAKAWAYS. ANY CHANGES TO THE PROPOSED SOAKAWAYS MUST BE APPROVED BY THE LOCAL AUTHORITY.

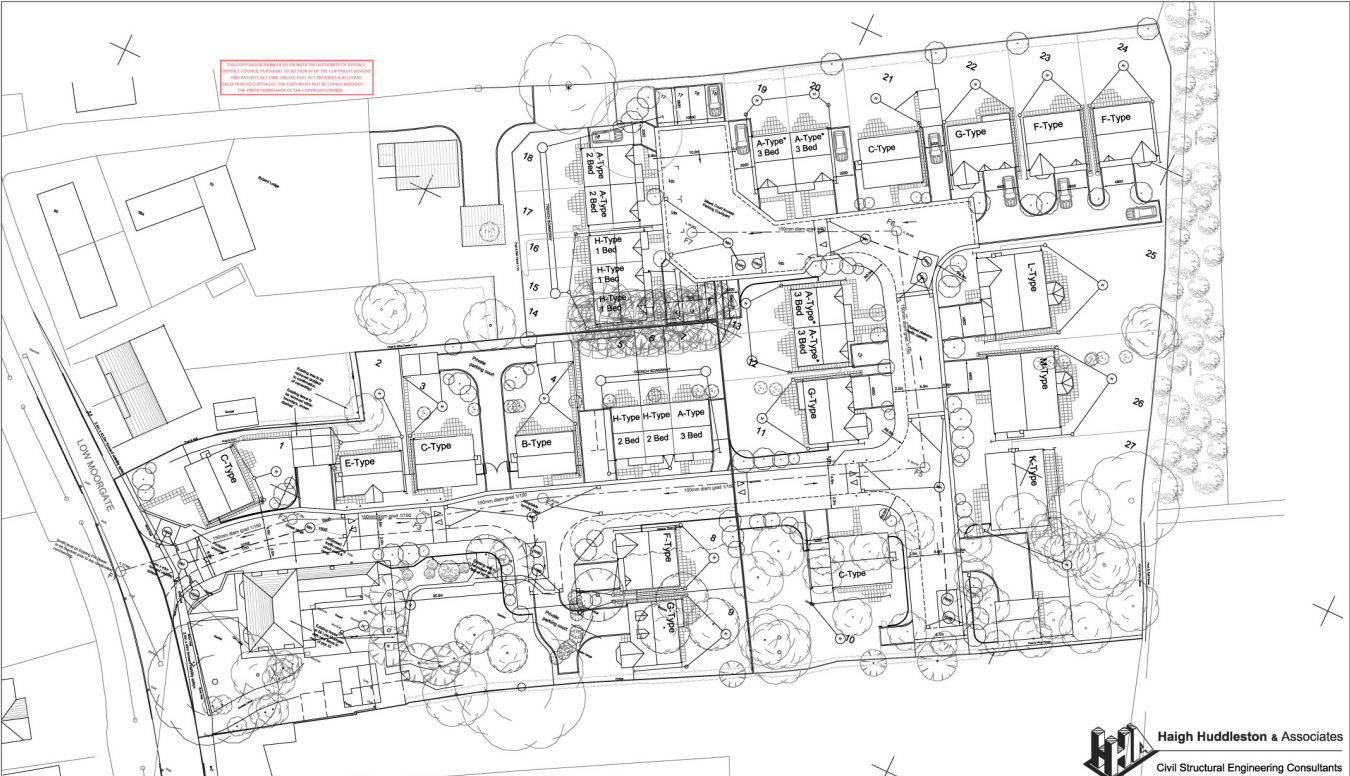

**ADDITIONAL PLAN**

- KEY:**
- HOUSE SOAKAWAY (H)
  - HIGHWAY SOAKAWAY (TYPE A) (HWA)
  - HIGHWAY SOAKAWAY (TYPE B) (HWB) (HWC)
  - HIGHWAY SOAKAWAY (TYPE C) (HWC) (HWC)
  - TRENCH SOAKAWAY

**Haigh Huddlestone & Associates**  
 Civil Structural Engineering Consultants  
 Fifth Buildings, 99-101 Leeds Rd, Dewsbury, WF12 7RZ  
 01924 464542 01924 459882  
 e: [info@haighhuddlestone.co.uk](mailto:info@haighhuddlestone.co.uk)

Client: Mr. J. B. COOK  
 Project: 56 LOW MOORGATE, RILLINGTON, MALTON

Date: PHASE 2 - PROPOSED SOAKAWAYS

Rev	Desc	Date	Drawn	Checked	Date	Scale	Drawn No.
Rev E	Revised to suit latest planning layout	05/09/2015	DG	MH	JUN/16	1:250 (M)	ET2/5666/04E
Rev D	Revised to suit latest planning layout	05/09/2015	DG	MH	JUN/16	1:250 (M)	ET2/5666/04E
Rev C	Revised to suit latest planning layout	05/09/2015	DG	MH	JUN/16	1:250 (M)	ET2/5666/04E
Rev B	Final drainage address	05/09/2015	DG	MH	JUN/16	1:250 (M)	ET2/5666/04E
Rev A	Phase 2 added	05/09/2015	DG	MH	JUN/16	1:250 (M)	ET2/5666/04E